

Nipolet 3000 lbs, 6000 lbs

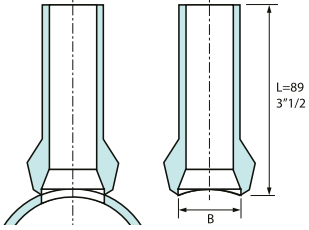

3000 lbs

Rozmery	B	Váha (kg/ks)
1/4"	16,0	0,20
3/8"	19,0	0,23
1/2"	24,0	0,25
3/4"	30,0	0,40
1"	36,5	0,65
1 1/4"	44,5	0,75
1 1/2"	50,8	0,95
2"	65,0	1,45

6000 lbs

Rozmery	B	Váha (kg/ks)
1/2"	14,0	0,25
3/4"	19,0	0,50
1"	25,5	0,70
1 1/4"	33,5	0,88
1 1/2"	38,0	1,15
2"	43,0	1,50

Ukončenie

plain end
 bevelled podľa ANSI B 16.25
 NPT podľa ANSI B1.20.1
 BSP

